

**PRODUCT DATA SHEET**

[RETURN TO WEB SITE](#)

Taking advantage of updated metal processing, Division 7 now offers wood grained and fabricated aluminum siding panel systems. The D7-WGP/FAS are available in 4" and 6" tall panels up to 10' in length. A custom designed splice plate allows for expansion and contraction of material while keeping the wood grain or solid color consistent. Stainless steel mounting clips hold the panels firmly to your substrate. The WGP is painted aluminum that mimics natural wood, panels are available in .040" thickness. The FAS is fabricated from solid color sheets and is available in .032" to .050" thicknesses. This system has been independently tested and meets the highest standards of the industry.

<b>D7-WGP/FAS Features and Information:</b>	
<b>System:</b>	Horizontal Panels with mounting clips and integral joinery
<b>Standard Reveal</b>	1"
<b>Underlayment</b>	Waterproofing Weather Barrier Required
<b>Required Substrate</b>	System is designed to your substrate specification and must be waterproofed prior to installation
<b>Radius Surfaces</b>	No
<b>System Depth</b>	5/8"
<b>Tested Certifications</b>	ASTM E283, E331, E330, E1233 and AAMA 501
<b>Required Maintenance</b>	Minimal: Clean with low pressure water and mild detergents
<b>Thermal Expansion</b>	YES
<b>Price</b>	Ranges with complexity of the project
<b>Weather Sealed</b>	NO
<b>Installation Rating</b>	Easy

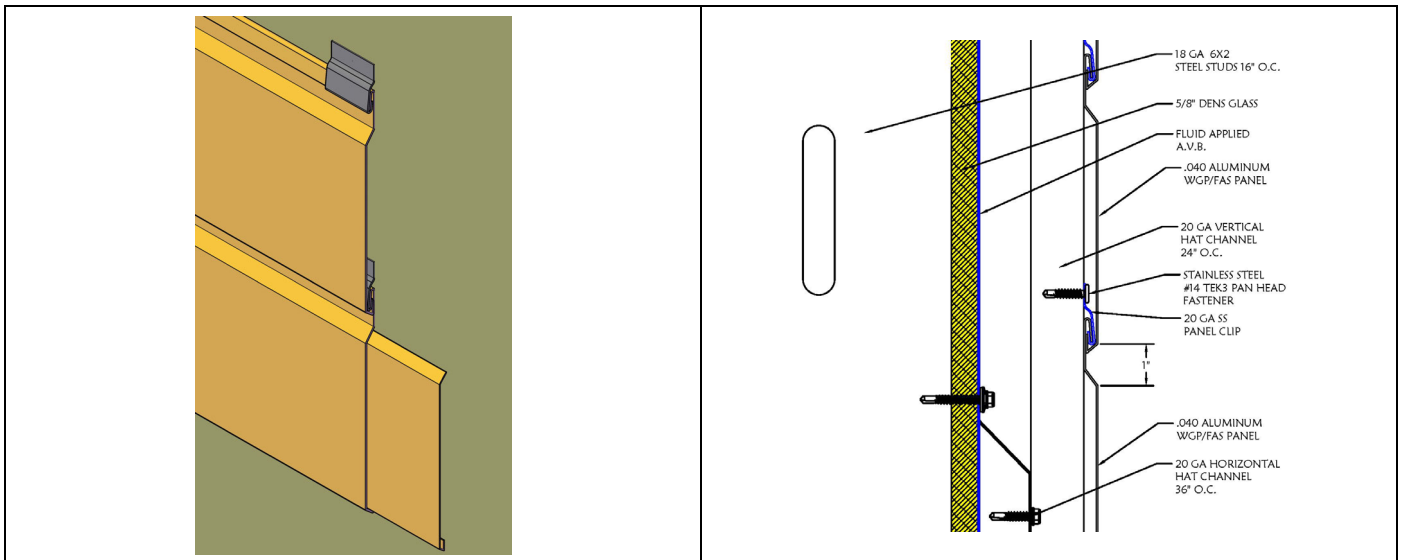

<p><b>Material Manufacturers:</b></p> <p>A wide variety of material manufacturers for wood grain or solid colors. Mill Finish and post painted for custom color.</p>	<p><b>Base Material Sizing:</b></p> <p>48" x 120" Standard</p>
<p><b>Material Thickness:</b></p> <p>.040" Standard Aluminum (3003) Other materials available</p>	<p><b>Mounting Clips:</b></p> <p>20 GA Stainless Steel</p>
<p><b>System Depth:</b></p> <p>5/8" Panels in 4" or 6" face x 120" standard Custom Systems Available</p>	<p><b>Fabrication Tolerances:</b></p> <p>Width: 0.02" nominal Length: 0.02" nominal Panel Depth: 0.02" nominal Square: 0.02" nominal</p>
<p><b>Standard Reveal:</b></p> <p>1" Standard Customer Systems Available</p>	<p><b>Performance Testing:</b></p> <p>ASTM E 283 - Static Air Infiltration ASTM E331 - Static Water Infiltration ASTM E330 - Structural Design Loads (40psf) ASTM E 1233 - Cyclic Air Pressure Differential AAMA 501 - Dynamic Water Infiltration</p>